

Facility Map

Second Floor

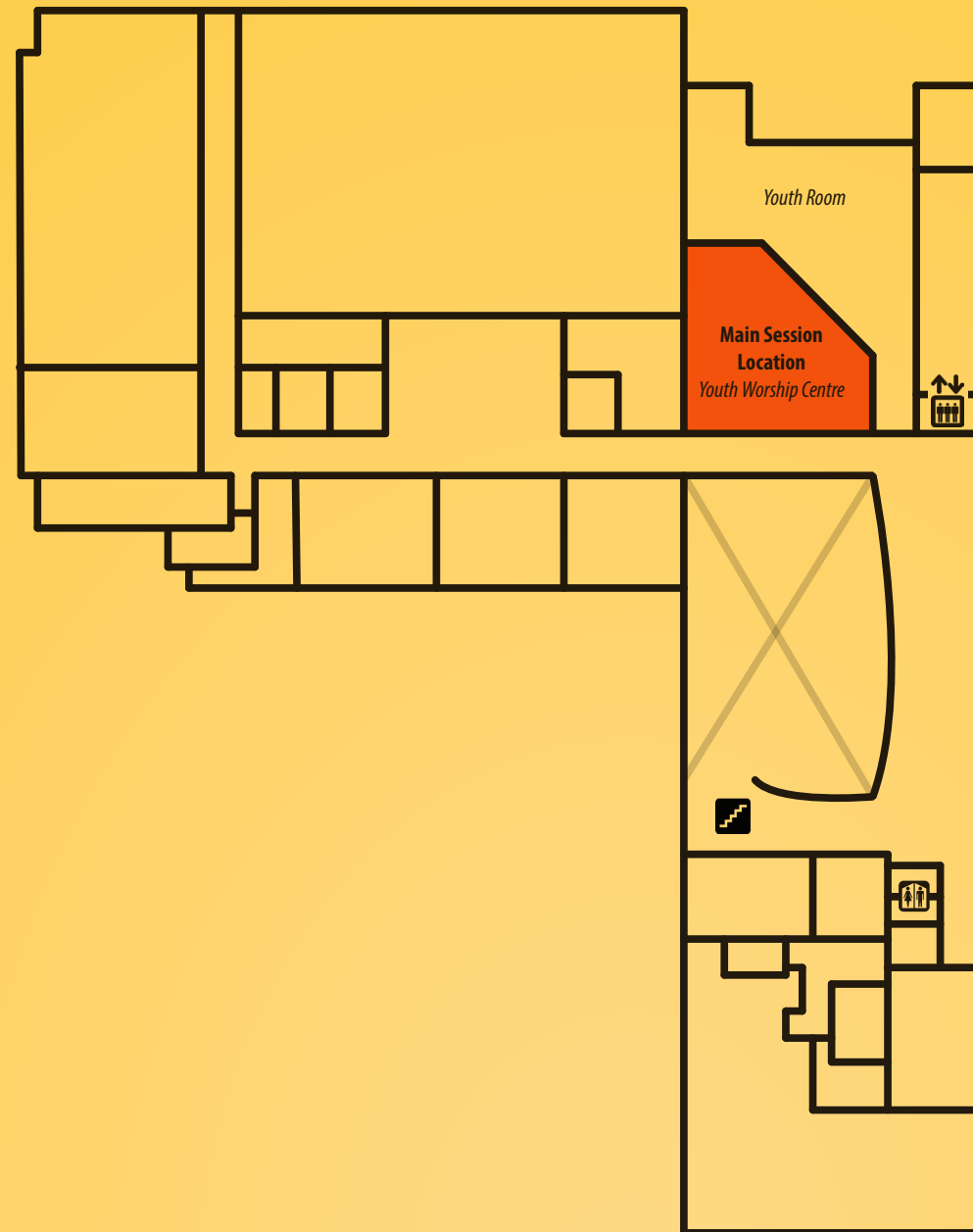

BUILDING COMMUNITIES *of* BELONGING

SATURDAY, MAY 3, 2014

HARVEST BIBLE CHAPEL 500 GREAT LAKES BOULEVARD, OAKVILLE

Christian Horizons
serving the person with exceptional needs

HARVEST
BIBLE CHAPEL

GOD CREATED EVERYONE IN HIS IMAGE AND WITH INTRINSIC VALUE.

This one-day conference will share practical strategies to develop and strengthen ministries of belonging, integrating people affected by disabilities. Focusing on church contexts, this event features workshops and sessions to inform and equip anyone with a passion to build...

“communities of belonging.”

Keynote Speakers



ERIK CARTER

Erik Carter is Associate Professor in the Dept. of Special Education at Vanderbilt University in Tennessee. Erik completed his graduate work in the area of severe disabilities. His research and teaching focus on strategies for supporting meaningful inclusion and promoting valued roles in school, work, and community for people with developmental disabilities.



TOM REYNOLDS

Tom Reynolds teaches theology at Emmanuel College in the University of Toronto. He lives as fulltime caregiver and advocate with his son, Chris, who is diagnosed on the autism spectrum. His book, *Vulnerable Communion*, reflects on this experience and seeks to envision a church wide with welcome.



CHANTAL HUININK

Chantal Huinink is a motivational speaker, author and social justice advocate who lives with a physical ‘disability’. She offers several workshops in partnership with Christian Horizons to ensure that church leaders and other allies have tools to acknowledge, encourage and utilize the God-given gifts and talents of people of all abilities in their churches and communities. Chantal is currently completing her Masters of Divinity and Social Work at Wilfrid Laurier University.

Conference Schedule

8:30 ^{am} –8:50 ^{am}	Registration
9:00 ^{am} –9:30 ^{am}	Welcome and Worship
9:30 ^{am} –10:15 ^{am}	Erik Carter
10:15 ^{am} –10:30 ^{am}	Break
10:30 ^{am} –11:30 ^{am}	Workshop
11:30 ^{am} –12:30 ^{am}	Lunch
12:30 ^{am} –1:00 ^{am}	Chantal Huinink
1:00 ^{am} –1:45 ^{am}	Panel/Q & A
1:45 ^{am} –2:00 ^{am}	Break
2:00 ^{am} –2:45 ^{am}	Tom Reynolds
2:45 ^{am} –3:00 ^{am}	Closing